

# ASSEMBLY GUIDE

## AnkerMake M5C 3D Printer

Model: V8110

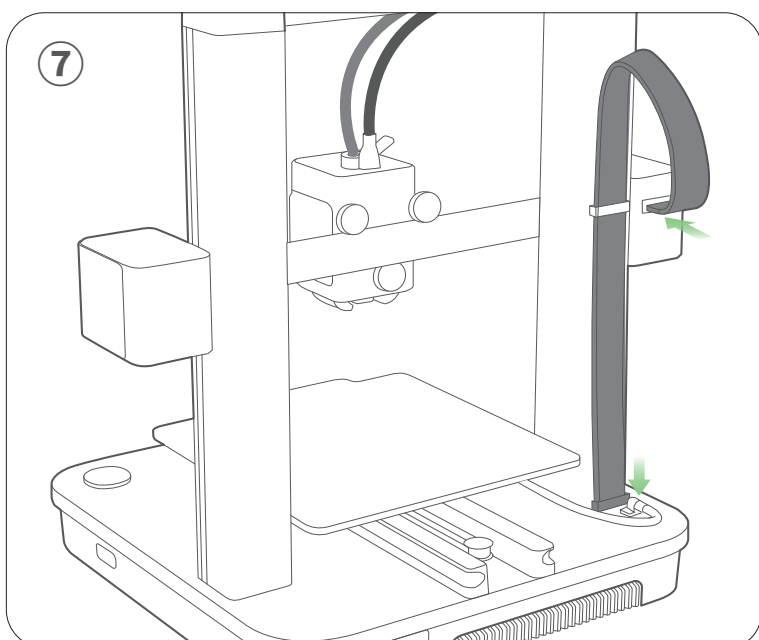
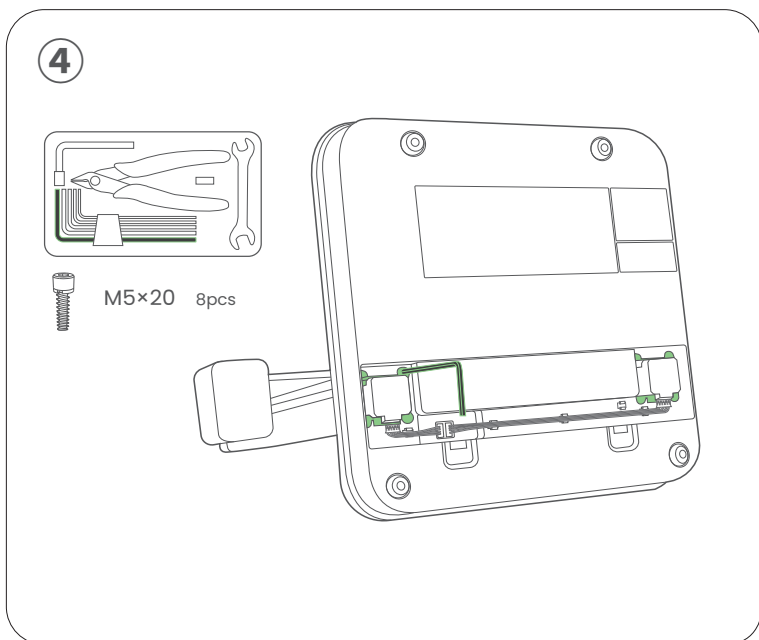
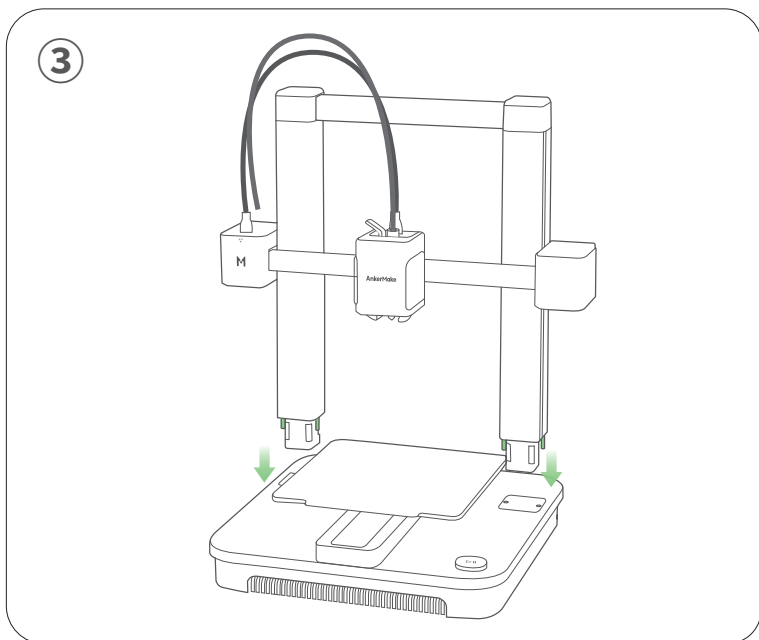
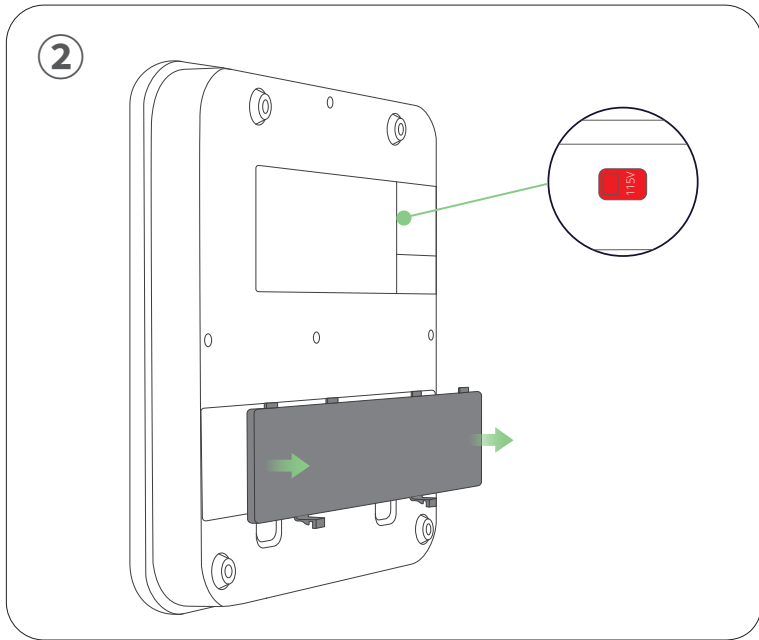
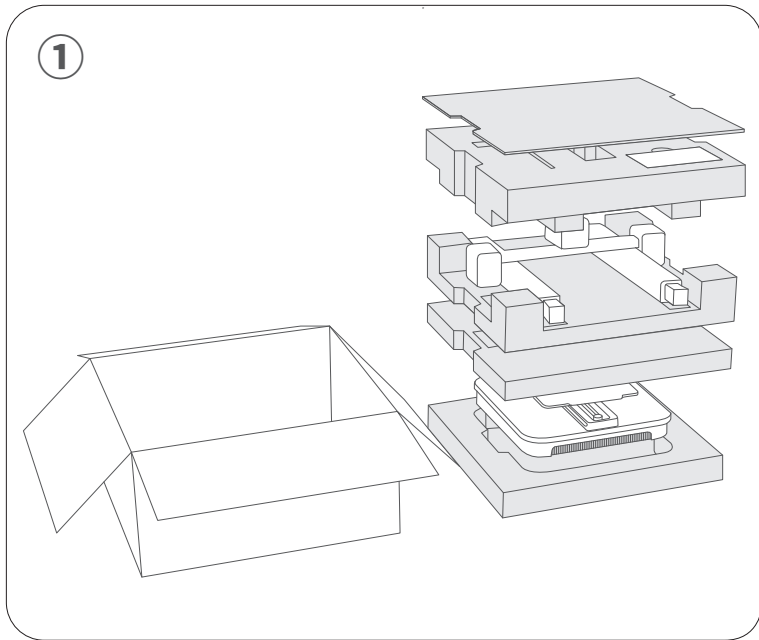

PTFE Feeding Tube  
Tubo de alimentación de PTFE  
Tube d'alimentation en PTFE

Extrusion Clip  
Clip de extrusión  
Clip d'extrusion

Wi-Fi/Bluetooth Indicator  
Indicador de Wi-Fi/Bluetooth  
Indicateur Wi-Fi/Bluetooth

LED Indicator  
Indicador LED  
Indicateur LED

Extruder  
Extrusor  
Extrudeur

Power Socket / Power Switch  
Enchufe de corriente /  
Interruptor de encendido  
Prise électrique /  
Interrupteur d'alimentation

Platform  
Plataforma  
Plateforme

Ventilation Holes  
Agujeros de ventilación  
Trous de ventilation

Filament Holder  
Soporte de filamento  
Porte-filament

Gantry Frame  
Marco de grúa  
Cadre de portique

Filament Slot  
Ranura del filamento  
Emplacement de  
filament

Nozzle  
Boquilla  
Buse

PEI Plate  
Placa PEI  
Plaque PEI

Operation Button  
Botón de operación  
Opération Bouton

USB-C Port / Reset Slot  
Puerto USB-C / Ranura  
de reinicio  
Port USB-C / Fente de  
réinitialisation

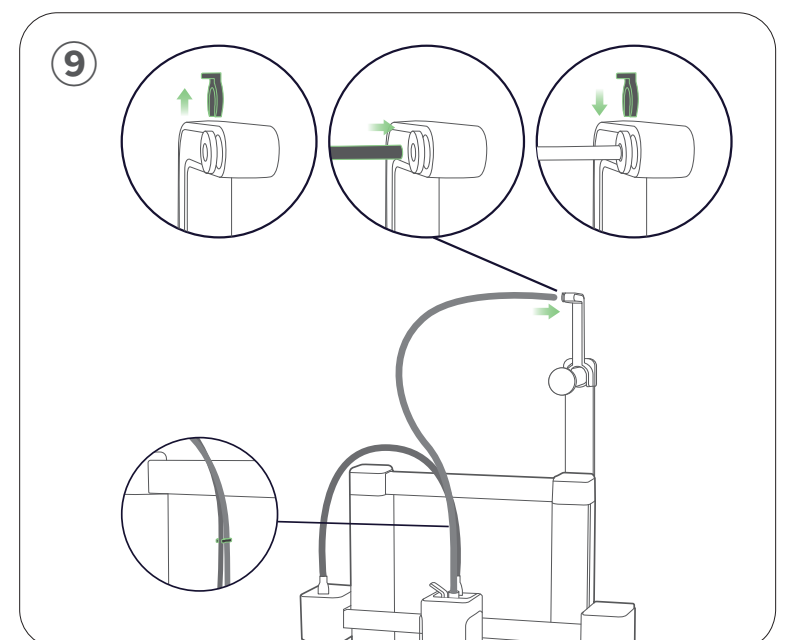
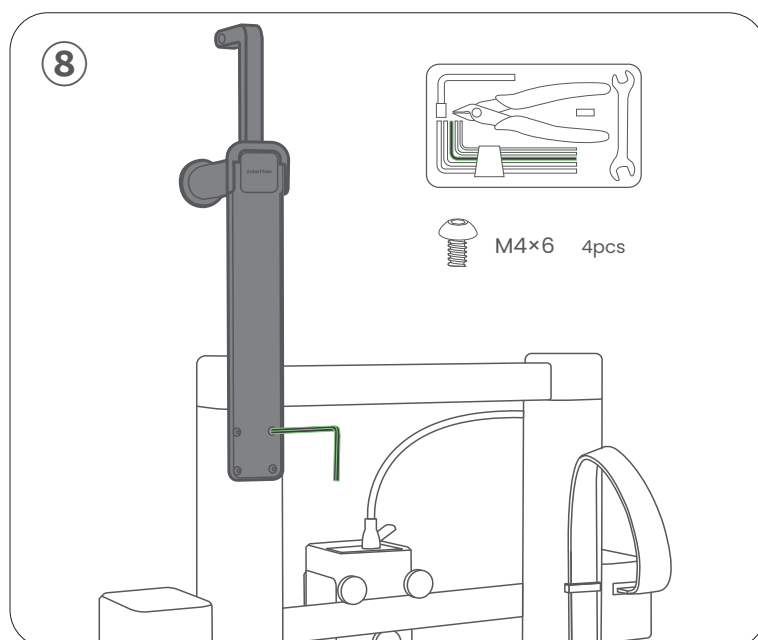
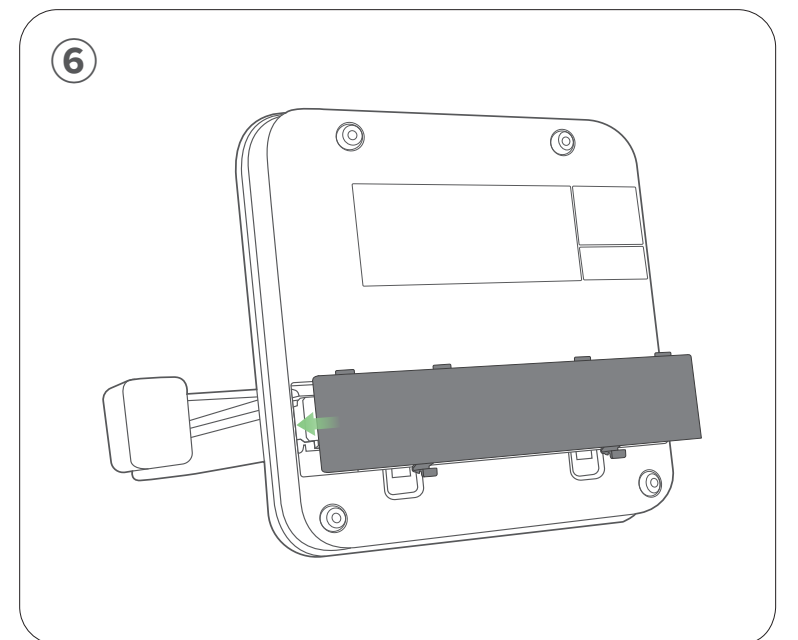
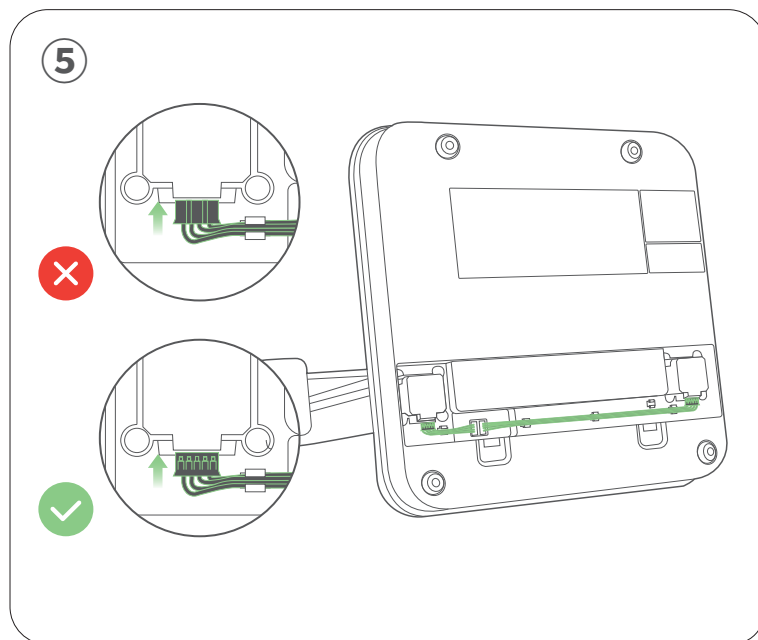

# QUICK START GUIDE

## AnkerMake M5C 3D Printer

 <https://support.ankermake.com/s/>

### 1 Powering On

Encendido  
Mise sous tension

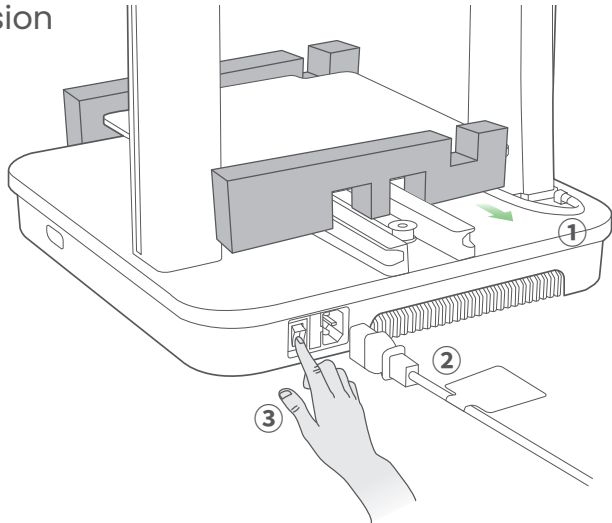

### 2 Setting up the System

Configuración el sistema  
Mise en place du système

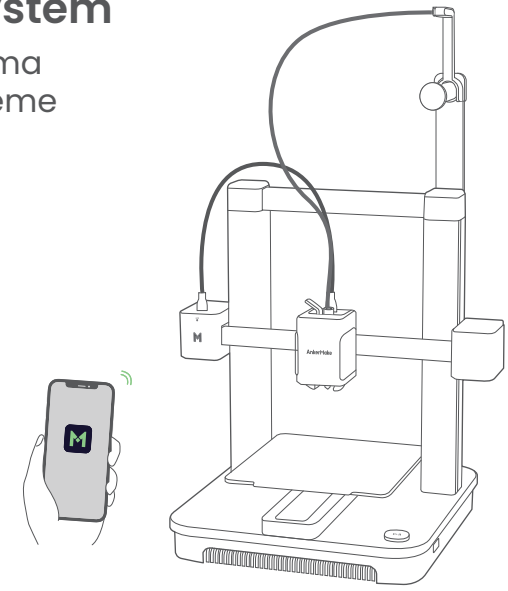

### 3 Leveling Heatbed

Nivelado de la cama caliente  
Nivellement du lit chauffant

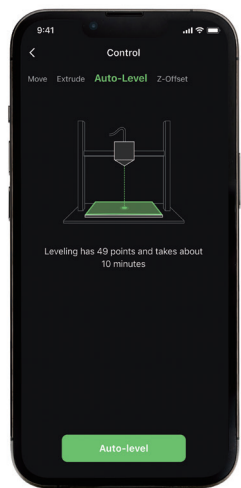

 Avoid moving the printer during the auto-leveling process.  
Procure no mover la impresora durante el proceso de nivelación automática.  
Évitez de déplacer l'imprimante pendant le processus d'auto-nivellement.

### 4 Loading Filament

Carga del filamento  
Chargement de filament

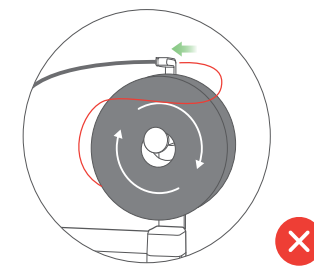
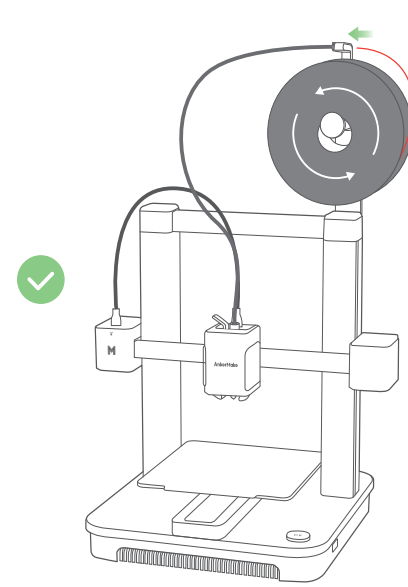

 Straighten the filament at least 0.78 inches / 2 cm and cut the tip of the filament at a 45° angle.  
Enderece el filamento al menos 2 cm y corte la punta del filamento en un ángulo de 45°.  
Redressez le filament d'au moins 0,78 pouces / 2 cm et coupez l'extrémité du filament en biais à un angle de 45°.

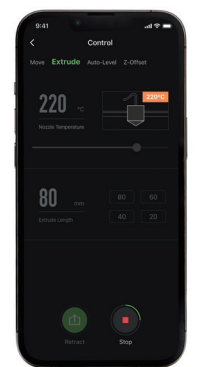
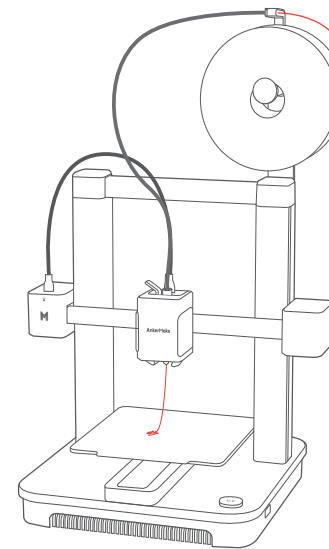
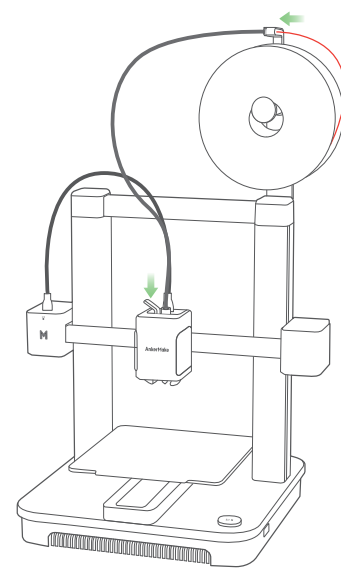

 Press and hold the extrusion clip while continuing to insert the filament. Stop when you feel some resistance.  
Presione y mantenga presionado el clip del extrusor mientras continúa insertando el filamento. Deténgase si nota alguna resistencia.  
Appuyez et maintenez le clip de l'extrudeur tout en continuant à insérer le filament. Arrêtez lorsque vous ressentez une certaine résistance.

### 5 AnkerMake Slicer

For the best printing experience, download and install the AnkerMake Slicer to your computer from Para obtener la mejor experiencia de impresión, descargue e instale el AnkerMake Slicer en su computadora desde Pour une expérience d'impression optimale, téléchargez et installez le trancheur AnkerMake sur votre ordinateur à partir de

[ankermake.com/software](https://ankermake.com/software)

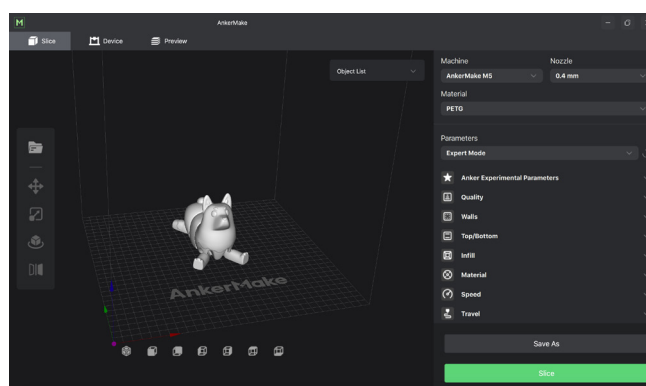

### 6 Printing

Impresión  
Impression

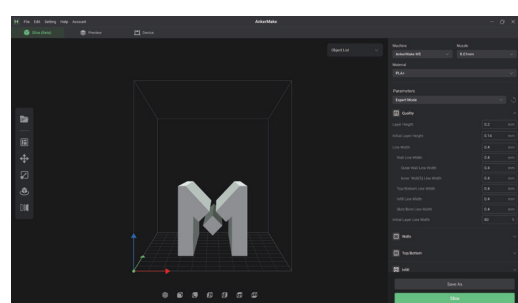
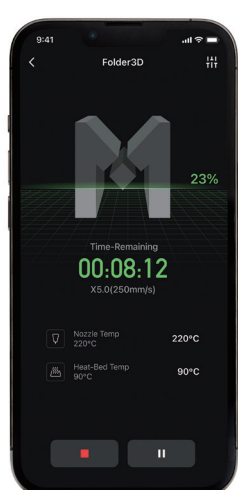

 12-month limited warranty | 12 Monate eingeschränkte Garantie | Garantía limitada de 12 meses | Garantie limitée de 12 mois | 12 mesi di garanzia limitata | 12 meses de garantía limitada | 通常保証 12 ヶ月 | 12 개월 제한 보증 | 12 شهرا كتميل دودجر ناهض | 12 مھسھ د گارانتیا لیمیتادا

Lifetime technical support | Technischer Support für die Produktlebensdauer | Asistencia técnica de por vida | Assistance technique à vie | Supporto tecnico per l'intero ciclo di vita | Suporte técnico ao longo da vida útil do produto | テクニカルサポート | 평생 기술 지원 | میاد یونکت مورج

 (US) +1 (800) 221-0126  
(UK) +44 (0)1604 936200  
(DE) +49 (0)69 9579 7960  
(Middle East & Africa) +971 520750842  
(UAE) +971 8000320817  
(KSA) +966 8008500030  
(Kuwait) +965 22069086  
(Egypt) +20 8000000826  
(AU) +61 3 8331 4800  
(TR) +90 (850) 460 14 14  
(RU) +8(800)511-86-23  
(中国) +86 400 0550036  
(日本) 03 4455 7823  
(한국) +82 02-1661-9246

 support@ankermake.com  
support.me@ankermake.com  
(Middle East & Africa)  
CED-CN@ankermake.com (中国)  
support@ankermake.com (日本)

Anker Innovations Limited  
Room 1318-19, Hollywood Plaza,  
610 Nathan Road, Mongkok,  
Kowloon, Hong Kong

